

HOME	MUZZLE BORESIGHTS	SENSOR POSITIONING	VIDEO PRODUCTS	COMPANY PROFILE	COMMENTS/ QUESTIONS
	PT40E 40# CAPACITY	PT75 75# CAPACITY	PT150 150# CAPACITY	SAMPLE GUI	

GRAFLEX...Sensor Positioners

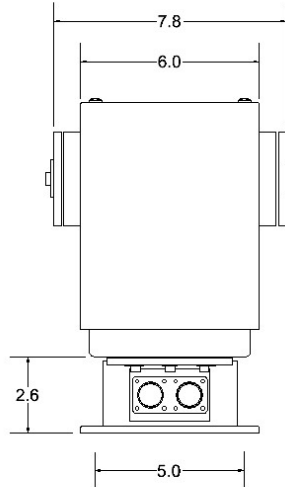
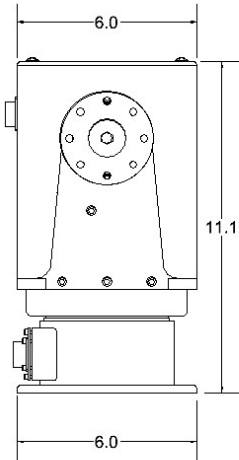

PT75 Highlights

- Mil 810 Tested & Certified
- 75 Pound Payload Capacity
- Very High Resolution, Accuracy and Repeatability
- Two Axis Stabilization
- Extremely Rugged Design
- Compact Design
- No Routine Maintenance Required
- Exceptional Travel Velocity
- GUI or RS- Controlled

MECHANICAL

Dimensions

7.8" (w) x 11.1" (h) x 6.0" (d)

Weight

33 Lbs

Base Dim's

6.0" Diameter

Base Mounting

Contact Factory

Construction

Aluminum and Stainless Steel

Color

Anodized or Painted & Stainless Steel

Payload Capacity

75 Lbs - Balanced

Drive Motor

Brush DC Servo

Travel Range

360° Continuous @ Azimuth

Holding Brake

5° thru 270° Fully Adjustable @ Elevation

Tilt Limits:

Worm Gear – Not Required

Backlash

Electrical, Mechanical, Software

None

COMMUNICATION

Interface

RS-422 or RS-232

Motor Controller

Microprocessor based

Sensor Pass-Thru

30 Ea – 2 Amp, 2 Ea - Coax
(Gyro & Heater Line NOT Included Above)

ELECTRICAL

Voltage

24Vdc (Nominal)

Power

Contact Factory

Heater

Optional – Pre-wired Std

OPERATIONAL

Travel Velocity

60°/Sec.- .005°/Sec.

Resolution

.00275°

Repeatability

.0055°

Accuracy

.0055°

Payload Inertia

8.6 ft-lb-sec² (Az.),
4.7 ft-lb-sec² (Elev.)

Feedback:

17 Bit Gurley Encoder
(Azimuth & Elevation)

OPTIONS

Coatings (Finish)

Payload Mount

Heaters

Stabilization – MEMS Gyro (Two-Axis)

Shock Mount

ENVIRONMENTAL (MIL 810E)

Operating Temperature: 501.00 Procedure II (1 Cycle @ 3 Hours Each -31.7° C and 51.7° C)
Note: These Ranges Require Heater Blanket

Humidity: 507.00 Procedure III (2 Cycles of 24 Hours @ 50° C and 100% Humidity)

Salt Fog: 509.00 Procedure I (1 Cycle of 24 Hours @ 5% Sodium Chloride)

Dust & Wind: 510.00 Procedure I (1 Cycle of 6 Hours)

Vibration (514.4): Axis

	<u>Frequency (Hz)</u>	<u>Amplitude</u>	30 Min/Axis
All	2.7 to 5.5	1.0" DA	
	5.5 to 38	± 1.5g	
	38 to 50	.002" DA	
	50 to 200	± 2.5g	

Shock (516.4):

6± .6g's, 11.0 ± 1.1 ms half sine wave applied in each direction of 3 mutually perpendicular axis. 20 ± 2.0 g's, 11.0 ± 1.1 ms half sine wave applied in each direction of 3 mutually perpendicular axis with Optional Shock Mount.